

Vanemar Temperature & Humidity Sensor User's Guide



*Please read the guide carefully before installing and using the device. The guide may be updated; access the latest version at support.vanemar.io.

DE Zur deutschen Bedienungsanleitung können Sie über den folgenden Link gelangen.
EL Μπορείτε να βρείτε το εγχειρίδιο χρήσης στα Ελληνικά στον παρακάτω σύνδεσμο.
ES Puede acceder al manual de usuario en Español a través del siguiente enlace.
FR Vous pouvez accéder au manuel d'utilisateur en Français via le lien ci-dessous.
HR Priružnik za korisnike na Hrvatskom možete pronaći na donjem linku.
IT Puoi accedere al manuale utente in Italiano tramite il link sottostante.
SL Do navodil za uporabo v Slovenščini lahko dostopate preko spodnje povezave.
SV Du kan nå användarhandboken på Svenska via länken nedan.
TR Türkçe dilindeki kullanim kılavuzuna aşağıdaki linkten ulaşabilirsiniz.
support.vanemar.io

Meet Vanemar Temperature & Humidity Sensor

Designed to keep you informed about your indoor climate, the sensor measures temperature and humidity, allowing you to monitor your environment's conditions.

Measures and displays temperature and humidity.

May warn when the device's battery is low.

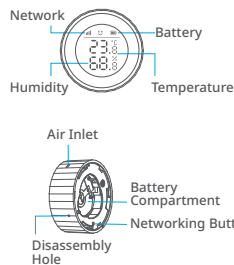

In the Box



Sensor



Desktop Bracket



Double-sided Adhesive Tape



Reset Tool

INSTALLATION

Safety And Preparation

Securing the Boat

Before beginning the installation, make sure the boat is stationary and securely moored to provide a stable environment.

Work Environment

Ensure the area is well-ventilated and free of clutter to facilitate a safe installation process.

INSTALLATION

① Pairing

Ensure the battery insulation pull tab is removed before pairing.

Open the Vanemar App. Tap '+' or 'Add device' button in the 'Devices' menu and follow the on-screen instructions.



INSTALLATION

② Fixing in Place

Pick an indoor spot for the device where temperature and humidity monitoring is essential, ensuring it's placed away from devices like air conditioners and heaters that could affect the measurements. For mounting options, please see the following pages.

Option 1: Wall Mounting

First, attach the adhesive tape to the back of the sensor. Then, press it against the wall to secure it in place. Make sure the wall surface is smooth, solid, dry, and clean before application.

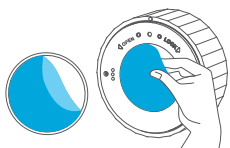

7

Option 2: Desktop Mounting

Attach the desktop bracket to the sensor's cover. Use the double-sided adhesive tape to ensure it stays securely in place, especially in moving conditions. Make sure the surface is smooth, firm, dry, and clean before applying the adhesive tape for a secure installation.

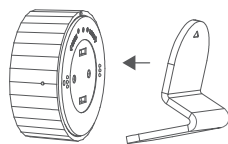

8

Indicators

Networking

Icon State	Status
Flashing	Searching for Gateway (Pairing Mode)
-	Unpaired
Solid	Paired

Battery



Status

Comfortable Temperature or humidity too high or too low

Using the Networking Button

To put your device into pairing mode, press and hold the networking button with the included reset tool until the 'all' on the screen starts flashing, indicating the device is ready to pair. Once successfully paired, the 'all' will remain steady.

To unpair, press and hold the networking button with the reset tool until the 'all' on the screen disappears, indicating disconnection.

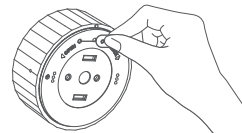

10

Opening/Closing the Cover

To Open the Cover

Insert the reset tool into the disassembly hole as shown in the below image, and rotate the cover toward the lock arrow direction, and rotate the cover toward the open arrow direction, and remove it from the sensor.

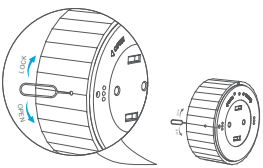

11

To Close the Cover

Align 'O' on cover and '●' on the sensor as shown in the below image, and rotate the cover toward the lock arrow direction to install it back to the sensor. When '●' and '●' are aligned, it indicates it's locked in place.

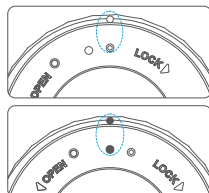

12

Changing the Battery

Keep an eye on the battery symbol on the device's screen and the Vanemar App for low battery alerts. The device needs a single CR2450 battery. Ensure the positive (+) side of the battery faces outward to match the plus (+) and minus (-) signs in the battery compartment. Please avoid using damaged or leaking batteries.

WARNING: Keep new and used batteries OUT OF REACH OF CHILDREN. This product contains a button cell or coin battery. DEATH or serious injury can occur if ingested.



13

Technical Specs

Model	H1
Working Voltage	DC3V (CR2450 battery)
Wireless Networking Distance	≤100 m (in the open area) ≤328 feet
Working Temperature	-10°C ~ +50°C -14°F ~ +122°F
Working Humidity	≤95%RH
Dimensions	42 x 42 x 17.8 mm 1.65 x 1.65 x 0.70 inches
FCC ID	2BEOZH1-EFR

14